

# Pressure sensors with internal diaphragm and ceramic element

Accuracy 0,5 % and 1 % according to IEC 61298-2

Standard output : 4...20 mA; 2-wire system  
 or 0...5 VDC; 3-wire system  
 or 0...10 VDC; 3-wire system



## Special features

High long-term stability  
 High peak pressure limits  
 For dynamic and static measurements

## Applications

For all gaseous and liquid pressure media, which do not attack the measuring system and do not crystallize or react viscous.

## Areas of use

Mechanical engineering  
 Hydraulics  
 Pneumatics

Model	SD-25	SD-26	SD-27	SD-28
Accuracy	1,0 % from full scale value		0,5 % from full scale value	
Connection thread	G 1/2 B	G 1/4 B	G 1/2 B	G 1/4 B
Ranges in bar	0...1,6, 2,5, 4, 6, 10, 16, 25, 40, 60, 100, 160, 250, 400 -1 / +1,5, -1 / +3, -1 / +5, -1 / +9, -1 / +15, -1 / +24			
Overload limit	up to 250 bar - 2x, 400 bar - 1,5x			
Sensor element	Ceramic in monolithical construction			
Repeatability	< 0,05 % full scale value			
Stability per year	< 0,2 % full scale value in rated conditions			
Case	CrNi steel			
Wetted parts	CrNi steel 316L, ceramic Al <sub>2</sub> O <sub>3</sub> , O-ring viton (FKM)			
Pressure connection	Hexagon 27 mm, CrNi steel 316L			
Electrical connection	Plug according to EN 175301-803 (DIN 43 650) / ISO 4401 with junction box			
Power supply	10...36 VDC (12...36 VDC for output 0...10 V)			
Power consumption	Output 4...20 mA: signal currency, with voltage output 8 mA			
Permissible load	Current 2-wire: $R_{max} = ((U_B - U_{B_{min}}) / 0,02)$ Ohm, voltage: $R_{min} = 10$ K Ohm			
Short-circuit protection	S + to U -			
Reverse polarity protection	U + to U -			
CE-conformity	Pressure Equipment Directive - 97/23/EG EMC-Directive to EN 61 326			
Operational life	> 50 million pressure cycles			
Temp.comp.range	0...85 °C			
Temp. influence	0,2 % / 10 K, zero point and span			
Response time	< 1 ms (within 10% to 90% of F. S.)			
Protection type	IP 65 to EN 60529 /IEC 529			
Temperatures	Medium: -20°C up to 100°C, Ambient: -25°C up to 80°C			
Weight	0,2 kg			

## Dimensions and Design

### Model SD-25 und SD-27

### Model SD-26 und SD-28

Standard version, IP 65

Plug according for EN 175301-803 (DIN 43 650) / ISO 4401 with junction box

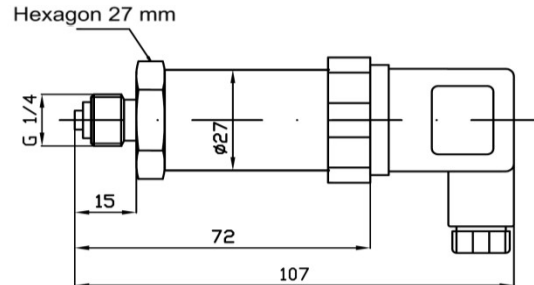
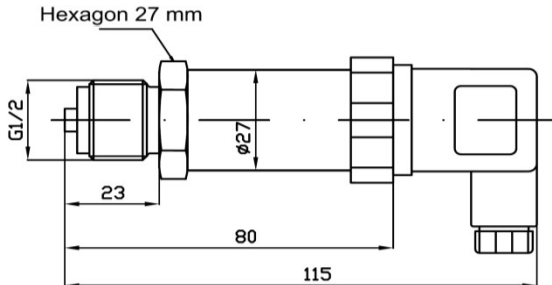

#### Two-wire system 4...20 mA

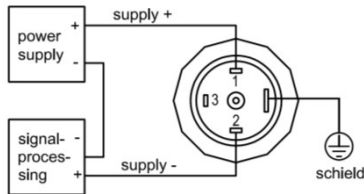

#### Three - wire system 0...20 mA and 0...5/10 V

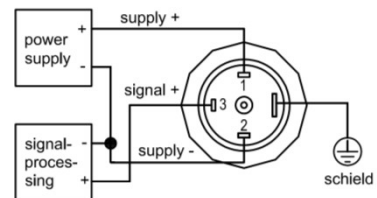

option, IP 67

Circular connector M 12 x 1, 4-pin

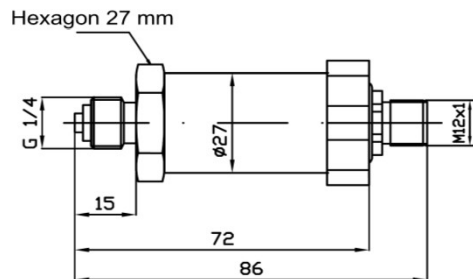
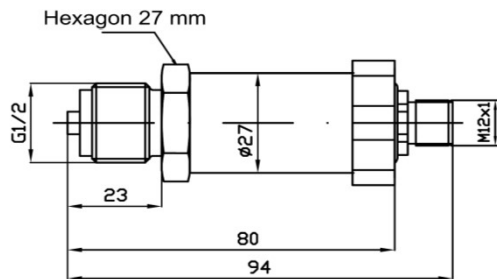

#### Two-wire system 4...20 mA

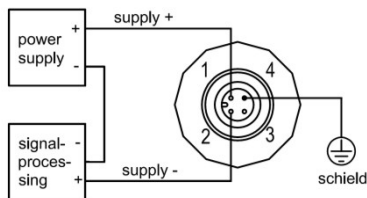

#### Three - wire system 0...20 mA and 0...5/10 V

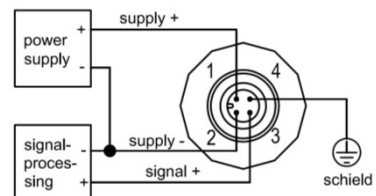

## Dimensions and Design

### Model SD-25 und SD-27

### Model SD-26 und SD-28

option, IP 67 oder IP 68  
cable outlet with 2 meters securely connected PVC-cable,

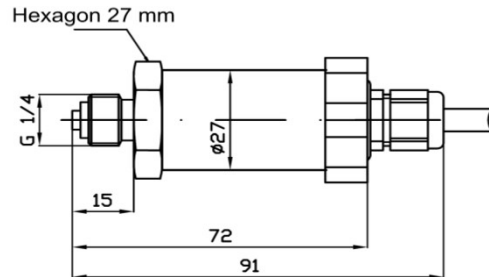
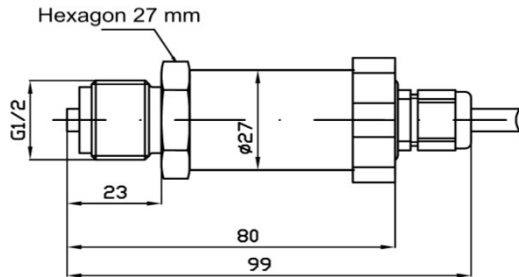

#### Two-wire system 4...20 mA

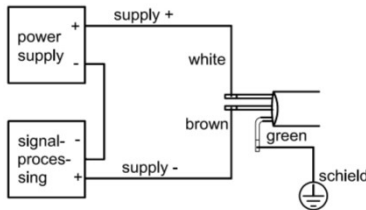

cable colours to DIN 47 100

#### Three - wire system 0...20 mA and 0...5/10 V

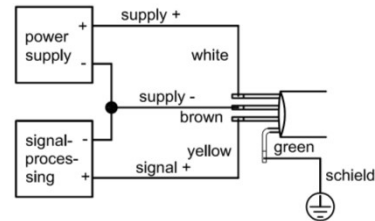

cable colours to DIN 47 100

option, IP 67  
compact field housing

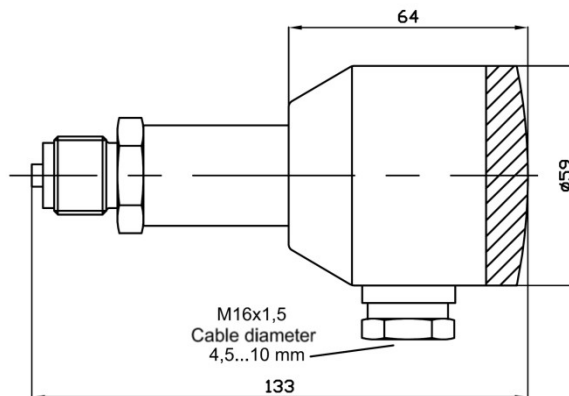

#### Two-wire system 4...20 mA

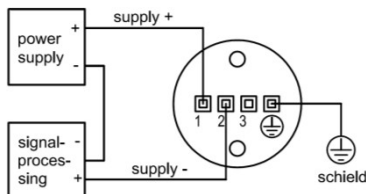

#### Three - wire system 0...20 mA and 0...5/10 V

