

Pressure sensors for precision measuring with internal diaphragm and stainless steel measuring cell

Accuracy: 0,1% according to IEC 61298-2

**Standard output : 4...20 mA; 2-wire system
or 0...10 VDC; 3-wire system**

Special features

- High overload protection
- Highly resistant to shock and vibration
- Good reproducibility

Applications

For all gaseous and liquid pressure media, which do not attack the measuring system and do not crystallize or react viscous.

Areas of use

Development and laboratory, Plant and apparatus construction, monitoring of measuring medium



Model	SD-36	SD-37
Accuracy	0,1 % of full scale value	
Connection thread	G 1/2 B	G 1/4 B
Ranges in bar	0...0,1, ...0,16, ...0,25, ...0,4, ...0,6, 1, 1,6, 2,5, 4, 6, 10, 16, 25, 40, 60, 100, 160, 0...250, 400, 600 -0,6 / 0, -1 / 0, -1 / +0,6, -1 / +1,5, -1 / +3, -1 / +5, -1 / +9, -1 / +15, -1 / +24	
Overload limit	doubly	
Sensor element	stainless steel measuring cell, to 40 bar piezoresistiv, from 60 bar thin film technology welded	
Repeatability	< 0,03 % full scale value	
Stability per year	< 0,2 % full scale value in rated conditions	
Case	CrNi steel	
Wetted parts	CrNi steel, to 40 bar with O-ring Viton (FKM)	
Pressure connection	Hexagon 27 mm, CrNi steel	
Electrical connection	Plug according to EN 175301-803 (DIN 43 650) / ISO 4401 with junction box	
Power supply	10...36 VDC (12...36 VDC for output 0...10 V)	
Power consumption	Output 4...20 mA: signal currency, with voltage output 8 mA	
Permissible load	Current 2-wire: $R_{max} = ((U_B - U_{B_{min}}) / 0,02) \text{ Ohm}$, voltage: $R_{min} = 10 \text{ K Ohm}$	
Short-circuit protection	S + to U -	
Reverse polarity protect	U + to U -	
CE-conformity	Pressure Equipment Directive - 97/23/EG EMC-Directive to EN 61 326	
Lebensdauer	> 50 million pressure cycles	
Temperaturkomp. Ber.	0...85 °C	
Temperatureinfluss	0,2 % / 10 K, zero point and span	
Einstellzeit	< 1 ms (within 10% to 90% of F. S.)	
Schutzart	IP 65 to EN 60529 / IEC 529	
Temperaturen	Medium: -20°C up to 100°C, Ambient: -25°C up to 80°C	
Gewicht	0,2 kg	

Dimensions and Design

Model SD-36

Model SD-37

Standard version, IP 65
 Plug according to EN 175301-803 (DIN 43 650) / ISO 4401 with junction box

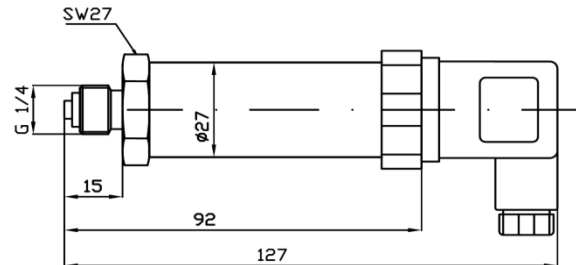
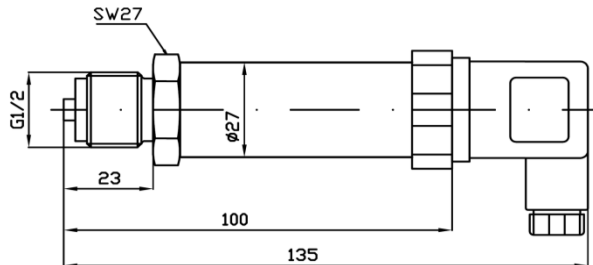

Two-wire system
 4...20 mA

Three - wire system
 0...20 mA and 0...5/10 V

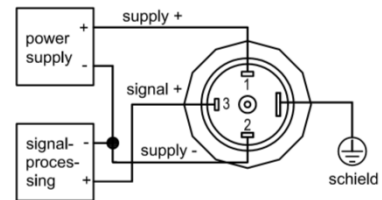
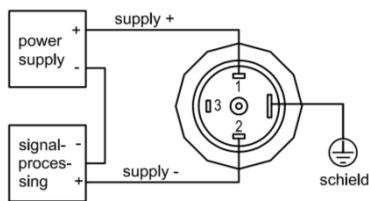

option, IP 67
 Circular connector M 12 x 1, 4-pin

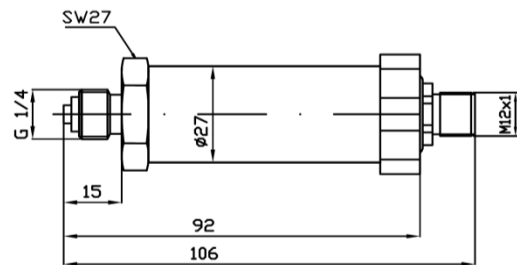
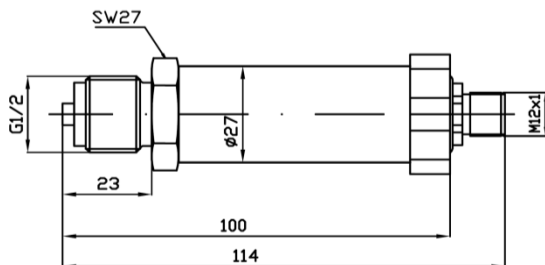

Two-wire system
 4...20 mA

Three - wire system
 0...20 mA and 0...5/10 V

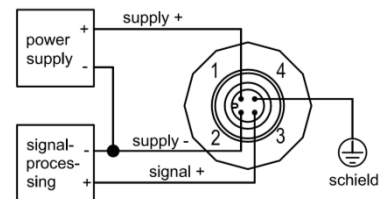
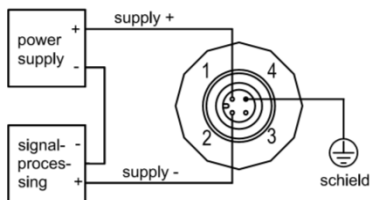

Dimensions and Design

Model SD-36

Model SD-37

option, IP 67 oder IP 68
cable outlet with 2 meters securely connected PVC-cable,

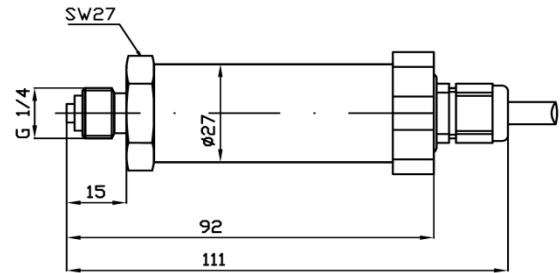
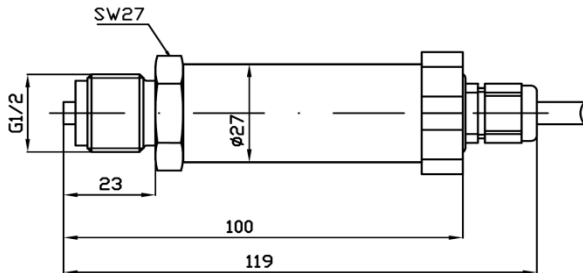

Two-wire system 4...20 mA

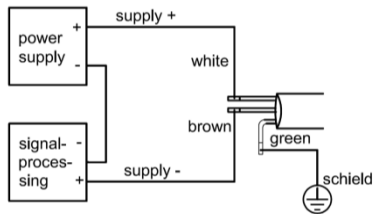

cable colours to DIN 47 100

Three - wire system 0...20 mA and 0...5/10 V

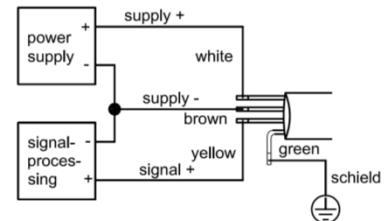

cable colours to DIN 47 100

option, IP 67
compact field housing

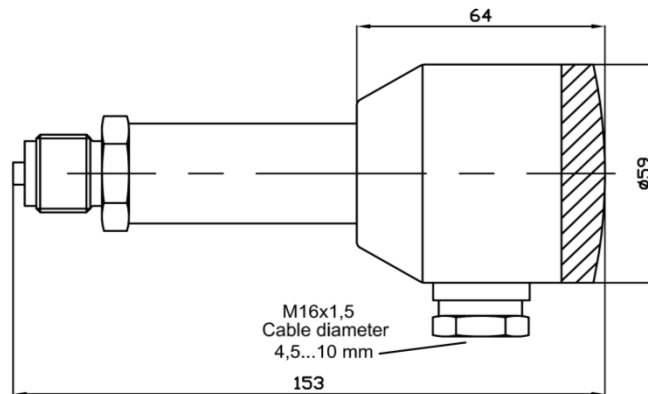

Two-wire system 4...20 mA

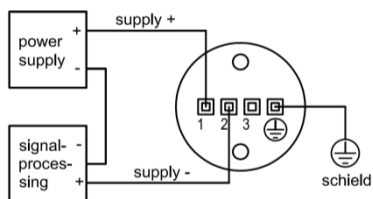

Three - wire system 0...20 mA and 0...5/10 V

