

Pressure sensor with front flush diaphragm in stainless steel

Accuracy 0,25 % and 0,5 % according to IEC 61298-2

Standard output 4...20 mA; 2-wire system
 or 0...20 mA; 3-wire system
 or 0...5 VDC; 3-wire system
 or 0...10 VDC; 3-wire system



Special features

high overload capacity
 high shock and vibration resistance
 for dynamic and static measurements

Applications

For highly viscous and crystallizing media
 for all gaseous and liquid pressure media,
 which do not attack the measuring system.

Areas of use

Machinery and plant engineering
 Environmental technology
 Water and wastewater technology

Model	SD-40	SD-42
Accuracy	0,5 % of full scale value	0,25 % of full scale value
Ranges in bar	0...0,1, ...0,25, ...0,4, ...0,6, 1, 1,6, 2,5, 4, 6, 10, 16, 25, 40, 60, 100, 160, 250, 0...400, 600 -0,6 / 0, -1 / 0, -1 / +0,6, -1 / +1,5, -1 / +3, -1 / +5, -1 / +9, -1 / +15, -1 / +24	
Overload limit	doubly	
Sensor element	stainless steel measuring cell, to 600 mbar piezoresistiv, from 1 bar thin film technology	
Repeatability	< 0,05 % full scale value	
Stability per year	< 0,2 % full scale value in rated conditions	
Case	CrNi steel	
Wetted parts	CrNi steel	
Pressure connection	Hexagon 27 mm, CrNi steel	
Connection thread	bis 600 mbar G 1", ab 1,0 bar G 1/2"	
Electrical connection	Plug according to EN 175301-803 (DIN 43 650) / ISO 4401 with junction box	
Power supply	10...36 VDC (12...36 VDC for output 0...10 V)	
Power consumption	Output 4...20 mA: signal currency, with voltage output 8 mA	
Permissible load	Current 2-wire: $R_{max} = ((UB-UB_{min}) / 0,02) \text{ Ohm}$, voltage: $R_{min} = 10 \text{ K Ohm}$	
Short-circuit protection	S + to U -	
Reverse polarity protection	U + to U -	
CE-conformity	Pressure Equipment Directive - 97/23/EG EMC-Directive to EN 61 326	
Operational life	> 50 million pressure cycles	
Temp.comp.range	0...85 °C	
Temp. influence	0,2 % / 10 K, zero point and span	
Response time	< 1 ms (within 10% to 90% of F. S.)	
Protection type	IP 65 to EN 60529 /IEC 529	
Temperatures	Medium: -20°C up to 100°C, Ambient: -25°C up to 80°C	
Weight	0,2 kg	

Dimensions and Design

Model SD-40 and SD-42

Standard version, IP 65
 Plug according to EN 175301-803 (DIN 43 650) / ISO 4401 with junction box

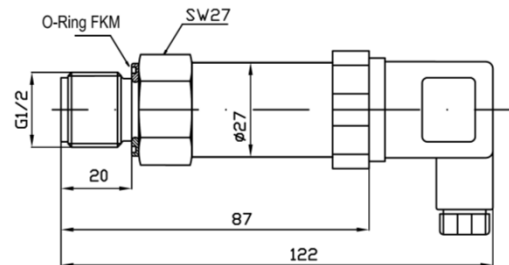
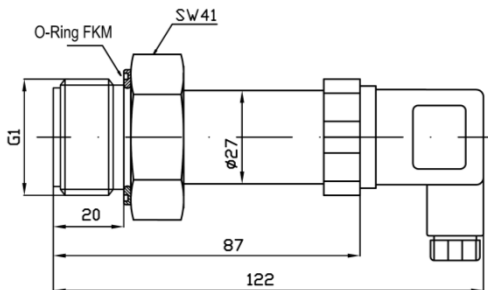

option, cooling element up to 200 °C or 300 °C

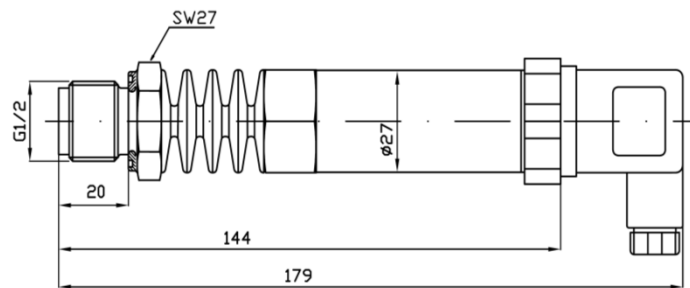

Two-wire system
 4...20 mA

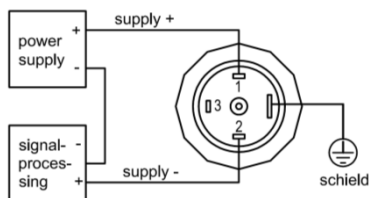

Three - wire system
 0...20 mA and 0...5/10 V

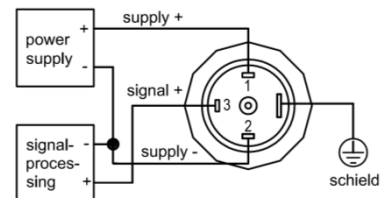

option, IP 67
 Circular connector M 12 x 1, 4-pin

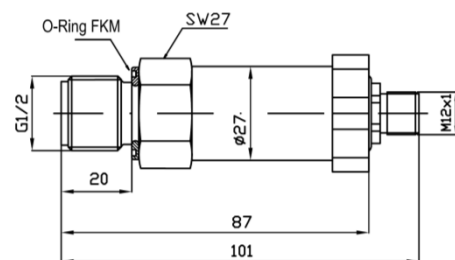
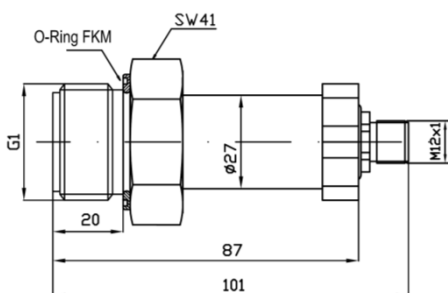

Two-wire system
 4...20 mA

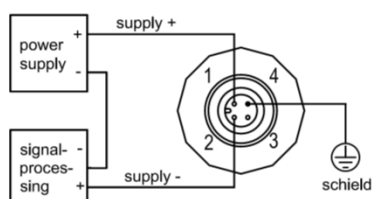

Three - wire system
 0...20 mA and 0...5/10 V

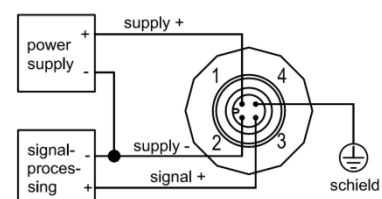

Dimensions and Design

Model SD-40 and SD-42

option, IP 67 oder IP 68
 cable outlet with 2 meters securely connected PVC-cable,

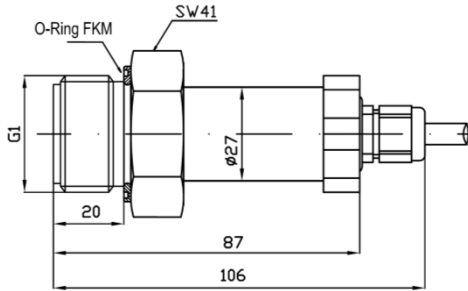

Two-wire system
 4...20 mA

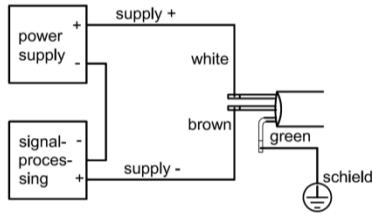

cable colours to DIN 47 100

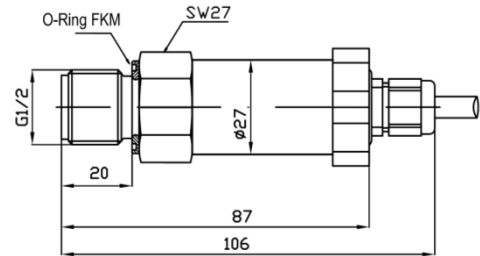

Three - wire system
 0...20 mA and 0...5/10 V

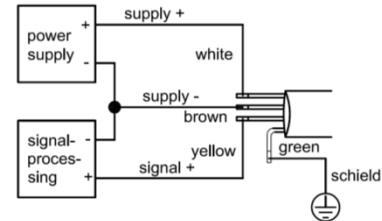

cable colours to DIN 47 100

option, IP 67
 compact field housing

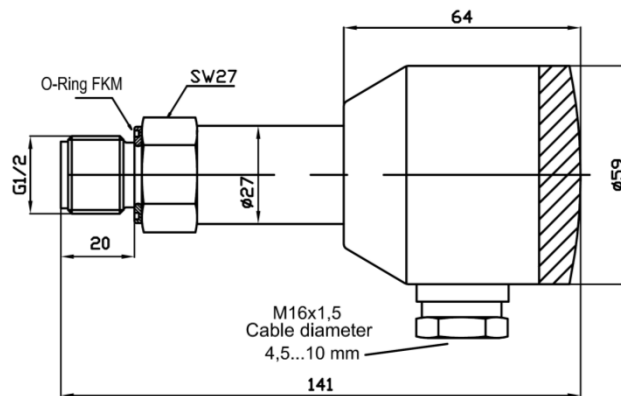

Two-wire system
 4...20 mA

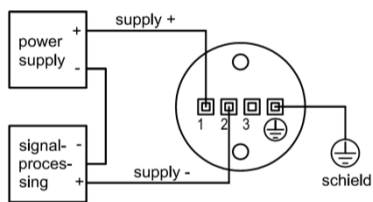

Three - wire system
 0...20 mA and 0...5/10 V

